

**Head Office**

**Vibco, Inc.**

75 Stilson Road  
Wyomomg, RI 02898  
TEL. 800-633-0032  
FAX. 401-539-2584



**Canadian Branch**

**Vibco Canada**

2215 Dunwin Drive  
Mississauga, Ontario L5L1X1  
TEL. 905-828-4191  
FAX. 905-828-5015

WWW.VIBCO.COM

**Operators Manual**

**Model TP-1830 High Compaction Dirt Plate Compactor  
Model TPA-1830 High Compaction Asphalt Plate Compactor**

**Engine Specs**

<b><u>Standard</u></b>	<b><u>Optional</u></b>
Honda GX-160	Robin EY-20
Four cycle, gasoline, air cooled	Four cycle, gasoline, air cooled
Overhead valve, slant cylinder	Vertical cylinder
Dual element heavy-duty air cleaner	Heavy-duty air cleaner
5.5 Horsepower / 4.1 Kilowatts	5.0 Horsepower / 3.7 Kilowatts
3250 RPM	3250 RPM
Rewind starter	Rewind starter
Low oil alert system	Low oil alert system
Transistorized magneto ignition	Magneto ignition

**Specifications**

<b><u>Specification</u></b>	<b><u>English</u></b>	<b><u>Metric</u></b>
Weight	160 lbs	73 kg
Centrifugal Force	3000 lbs	13.3 kN
Specific Centrifugal Force	11.8 psi	81 kPa
Vibration Frequency	5200 VPM	87 hz
Compaction Depth	12"	30 cm
Contact Dimensions	17" width x 15" length	43 cm x 38 cm
Overall Width	18"	46 cm
Overall Length	21"	53 cm
Water Tank Capacity	5 Quarts	4.7 Liters

## **Introduction**

Vibco plate type compactors are used for compacting loose layers of soil or asphalt into load bearing surfaces. The vibration aligns the particles in the material being compacted in order to achieve maximum density, thus eliminating hollow spaces or cavities. They are successfully used for sandy, granular and partially cohesive materials, as well as for asphalt finishing. The main components of the compactors are; the base plate, vibratory element, engine plate, steering handle and a water tank on asphalt models. The vibrational force and forward motion of these machines is induced by rotation of an eccentrically weighted shaft. The water tank on asphalt models wets the plate and pavement surfaces appropriately to avoid the adhesion, which can occur with the asphalt surface.

## **Serial Number Location**

### **Engine**

When ordering replacement parts from the engine distributor, state the model, specification and serial number. Model and spec. numbers for both engines are located on the flywheel cover. Honda serial numbers are found on the front of the crankcase housing and the Robin serial numbers are located on the base of the engine.

### **Compactor**

The Vibco model and serial numbers are mounted on the front of the engine plate. Furnish both numbers when corresponding with your authorized dealer.

## **Maintenance**

*Keep your machine clean!*

### **Every 10 hours or daily**

1. Periodically check bolts and nuts for tightness, especially in the period following initial operation.
2. Check engine oil daily.
3. Clear air filter periodically
4. Check and tighten element clamp screws with a torque wrench for 38-40 ft-lbs.

### **Every 50 hours or weekly**

1. Check belt tension.
2. Change engine oil.
3. Check and tighten all nuts and bolts.
4. If water flow through the sprinkler pipe on asphalt units fails, clear pipe using carburetor cleaner.
5. Check vibrator element seal for leaks.

## Operating Notes

- ◆ Before starting the machine, READ the engine-operating manual CAREFULLY.
- ◆ Remember to check the engine oil.
- ◆ Make sure the belt guard is securely bolted in place.
- ◆ The vibratory element is filled with 3 fluid ounces of SAE 90 EP gear lubricant, and is sealed at the factory. Note! Do not overfill the element if servicing, this can damage the unit extensively and may void the warranty.
- ◆ Unlock the handle by removing the pin and lowering the handle to the desired position. Reinsert the pin and the machine is ready to start.
- ◆ After warm up, move the control lever to full throttle position. The motor should run at 3250 RPM maximum. The clutch will automatically engage at approximately 1850 RPM, and vibration will begin. The unit will now begin to pull itself forward.
- ◆ Let compactor move on its own power, and guide it by the handle. Uneven or sloping terrain may cause the machine to slide sideways. The operator must then steer toward the rise thus causing the compactor to travel at an angle.
- ◆ Do not add fuel while the engine is running. Stop the engine, and if possible, allow a cooling period to prevent spilled fuel from igniting on contact with hot engine parts.
- ◆ **Before** making any adjustments, disconnect the spark plug cable to prevent unintentional starting.
- ◆ Make sure that the belt guard is securely bolted in place.
- ◆ REMEMBER a careful operator is always the best insurance against accidents.

Vibco, Inc. reserves the right to change and improve any parts or specifications without notice, and without incurring any obligation relating to such change.

**SILENT**  
We're The Vibrator Guys™

**VIBCO, INC.**

In Canada:



P.O. Box 8  
Wyoming, RI 02898  
Phone: 401-539-2392  
800-465-9709  
FAX: 401-539-2548

2215 Durwin Drive  
Mississauga, Ont. L5L 1X1  
905-828-4191  
800-465-9709  
FAX: 905-828-5015

**Model: TP-1830, TPA-1830**

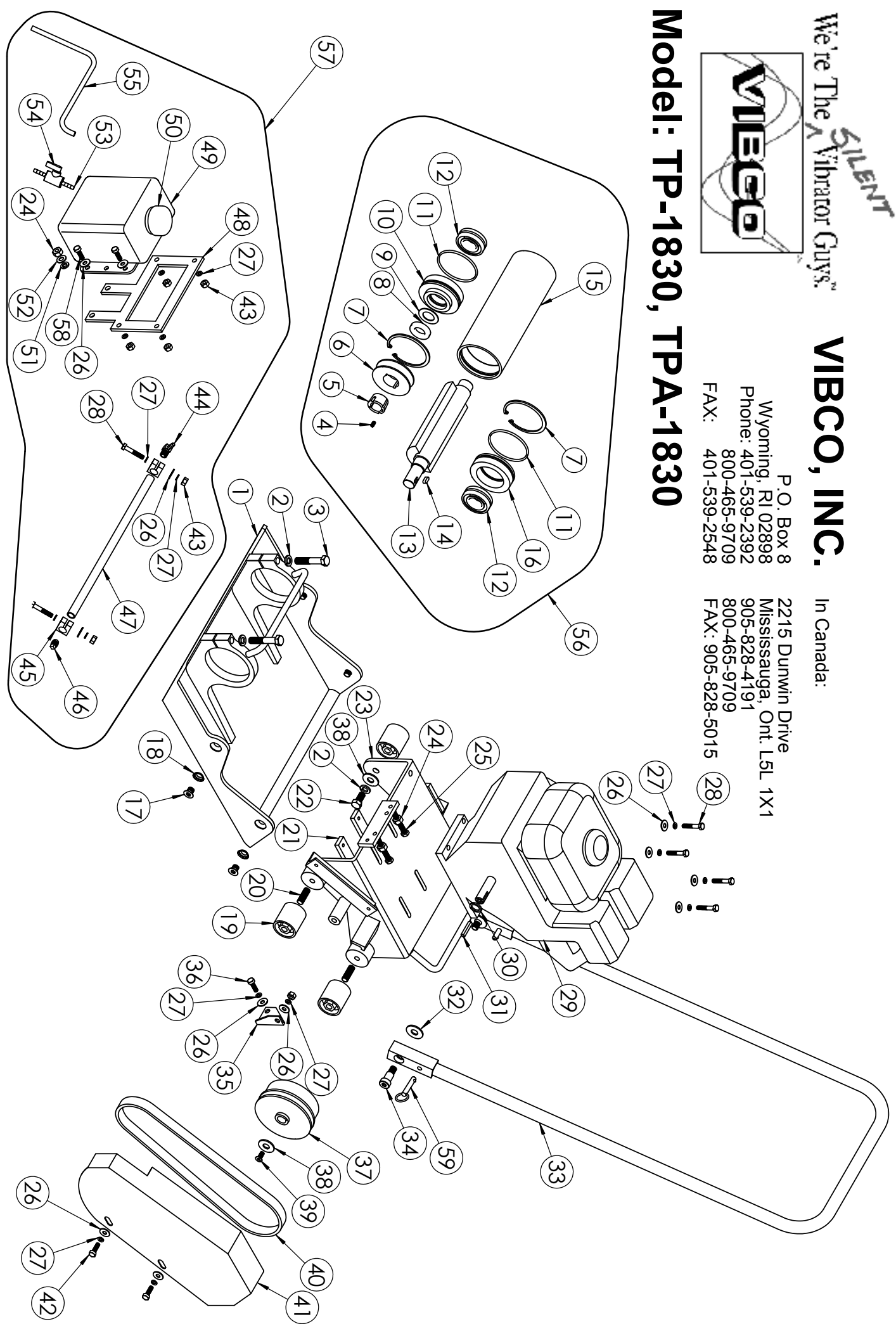

**Model: TP-1830H, TP-1830R, TPA-1830H, TPA-1830R**

Item Number	Part Description	Part Number		Number Required
		Honda	Robin	
1	Baseplate	201059	-	1
2	Lock Washer	1/2LW	-	4
3	Hex Head Bolt	1/2-20X2-3/4HH	-	2
4	Socket Set Screw	1/4-20X1/2SS	-	1
5	Bushing	201016	-	1
6	Sheave	201015-1	-	1
7	Retaining Ring	201022	-	2
8	C.R. Seal	201025	-	1
9	Oil Shield	201143	-	1
10	Bearing Housing (Open)	122020	-	1
11	O-Ring	122026	-	2
12	Bearing	201023	-	2
13	Eccentric Shaft	122019-2	-	1
14	Key (Shaft)	201017	-	1
15	Housing	120224-2	-	1
16	Bearing Housing (Closed)	122021	-	1
17	Flat Socket Head Cap Screw	1/2-13X5/8FSH	-	4
18	Star Washer	1/2SW	-	4
19	Shock Absorber	201028	-	4
20	Socket Set Screw	1/2-13X1-1/2SS	-	2
21	Sliding Flat	201034	-	2
22	Hex Head Bolt	1/2-13X1HH	-	2
23	Engine Plate	201032	-	1
24	Hex Nut	3/8-16HN	-	4
25	Hex Head Bolt	3/8-16X2-1/2HH	-	2
26	Flat Washer	5/16FW	-	14
27	Lock Washer	5/16LW	-	15
28	Hex Head Bolt	5/16-18X1-3/4HH	-	6
29	Engine	GX-160	EY-20	1
30	Clutch Spacer	18VR043	-	1
31	Key (Clutch)	201084	-	1
32	Flat Washer	9/16FW	-	2
33	Handle	201100	-	1
34	Shoulder Bolt	201140	-	2
35	Belt Guard Bracket	201142	-	1
36	Hex Head Bolt	M8X1.25X16MM	-	1
37	Clutch	201095	-	1
38	Flat Washer	1/2FW	-	3
39	Flat Socket Head Cap Screw]	5/16-24X3/4FSH	-	1
40	Belt	201128	-	1
41	Belt Guard	201098	-	1
42	Hex Head Bolt	M8X1.25X25MM	-	2
43	Hex Nut	5/16-18HN	-	2
44	90° Barb	122030	-	1
45	Sprinkler Clamp	201129	-	2
46	Pipe Plug (Plastic)	122041	-	1
47	Sprinkler Pipe	122103-2	-	1
48	Water Tank Bracket	122051-2	122051-1	1
49	Water Tank	201204	-	1
50	Water Tank Cap	201205	-	1
51	Flat Washer	3/8FW	-	2
52	Lock Washer	3/8LW	-	2
53	Dixon Clamp	133	-	4
54	Flow Valve	201134	-	1
55	Hose (2ft.)	122094	-	1
56	Element Complete	122018-2	-	1
57	Water System Complete	201014-2	201014-1	1
58	Hex Head Bolt	5/16-18X1HH	-	4
59	Handle Lock Pin	201033	-	1